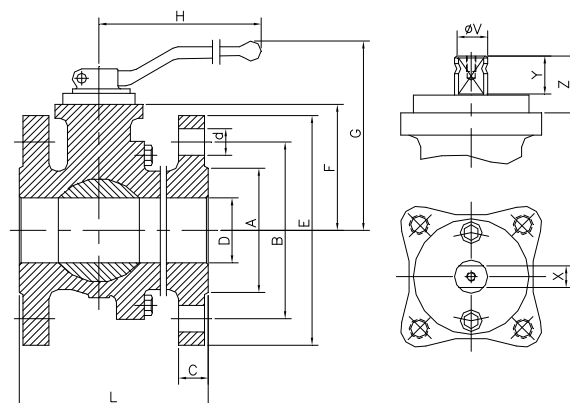
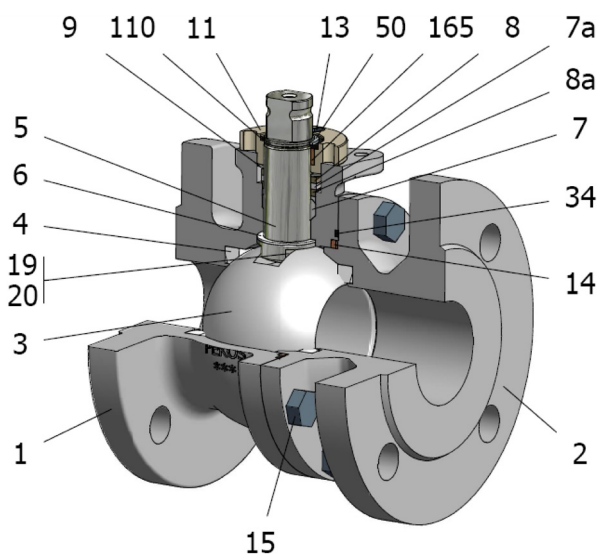

FIG.Z 04 TTTG PN10 DN15/200 F4-F5



Position	Description	Material
01	Body 1	C.S. 1.0619
02	Body 2	C.S. 1.0619
03	Ball	S.S. 1.4408
04	Seat	PTFE
05	Stem	S.S. 1.4401
06	Stem seal	PTFE+FG
07	Stem packing 1	PTFE
07a	Stem packing 2	Graphite
08	Gland packing 1	S.S. 1.4401
08a	Gland packing 2	S.S. 1.4401
09	Spring washer	S.S. 1.4310
11	Cover	S.S. 1.4408
13	Cover bolt	A4-70
14	Body seal 1	PTFE
15	Body bolt	A2-70
16	Handle	WCB
17	Handle bolt	1045(8.8)
19	Spring	S.S. 1.4319
20	Ball	S.S. 1.4401
34	Body seal 2	Graphite
50	Subjection ring	S.S. 1.4301
110	Subjection ring seal	S.S. 1.4401 Nitrided
165	Stem bearing	PTFE+FG

General features

- Floating ball.
- Split body.
- Full bore.
- Soft seat.
- Bidirectional.
- Fire Safe.
- TA-LUFT.
- Anti Blow out proof stem.
- Autoadjustable packing.
- Anti static device.
- Self-cavity pressure relief.

Standards

- Top flange ISO 5211
- Flanges EN 1092-01
- Face to face EN 558
- Testing EN-12266, ISO 5208
- Design EN-12516, ISO 17292

Official approvals

- CERTIFICATE FIRE SAFE
- TÜV.AD-MERKBLATT WO
- TA-LUFT
- ATEX 94-9EC
- API 6D.
- PED 97/23/CE.
- SIL 3
- EN 161/EN 264

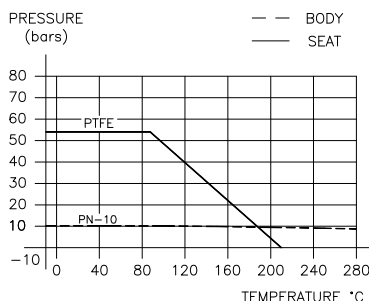

PEKOS GROUP CERTIFICATES:

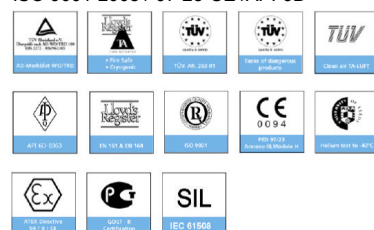

DIMENSIONS & Technical information

DN	PN	D	L	E	A	B	C	F	H	G	V	X	Y	Z	n x d	ISO 5211	Torque	Weight
15	10	15	115	95	45	65	16	52	185	100	14	11	11	13,5	4 x 14	F05	7	3,0
20	10	20	120	105	58	75	18	54	185	102	14	11	11	13,5	4 x 14	F05	9	3,8
25	10	25	125	115	68	85	18	60	185	110	18	14	17	19,5	4 x 14	F05	13	4,7
32	10	32	130	140	78	100	18	65	185	115	18	14	17	19,5	4 x 18	F05	20	6,5
40	10	40	140	150	88	110	18	75	293	129	22	17	20	30	4 x 18	F07	29	8,2
50	10	50	150	165	102	125	20	83	293	137	22	17	20	30	4 x 18	F07	40	11,2
65	10	65	170	185	122	145	18	96	293	150	22	17	20	30	4 x 18	F07	50	16,9
80	10	80	180	200	138	160	20	114	350	187	28	22	22	40	8 x 18	F10	80	22,2
100	10	100	190	220	158	180	20	128	350	201	28	22	22	40	8 x 18	F10	100	30,0
125	10	125	325	250	188	210	22	158	680	247	36	27	35	50	8 x 18	F12	220	56,0
150	10	150	350	285	212	240	22	175	680	264	36	27	35	50	8 x 22	F12	350	75,0
200	10	200	400	340	268	295	24	245	750	334	48	36	40	63	8 x 22	F14	500	134,0

** Depending on service conditions.

* Dimensions are in mm.

* Torque is in Nm.

* Weight is in Kilograms